

TVFix

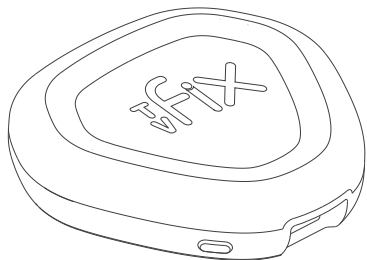

Hardware Installation:

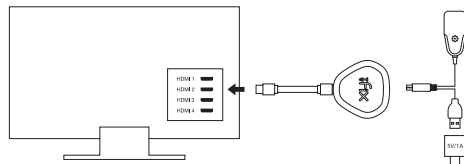

1. Plug the provided Wi-Fi adapter to your TVFix using the Micro USB port.
2. Plug the USB port into an external 5V/1A power adapter (not included).

Tip: If your TV has a USB port, you can use this if it provides at least 1A of power. If not, use a wall power adapter.

3. Plug the TVFix HDMI port into your TV, projector, or monitor HDMI input.
4. Select Source: Select the correct HDMI source on your TV, projector, or monitor. Once connected correctly, you will see the main setup screen.

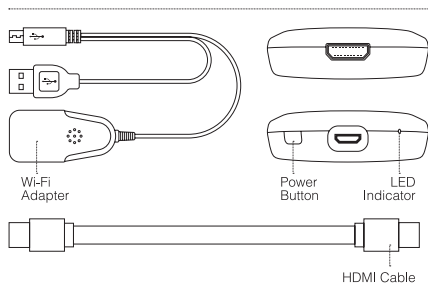
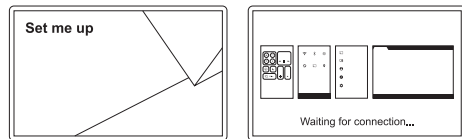

Connecting Your TVFix:

1. Connect your TVFix to your Wi-Fi.
 - a. Go to the Wi-Fi settings of your device, then search for the network 'ScreenCaster-xxxxxx'
 - b. Enter the the password 12345678 when prompted.

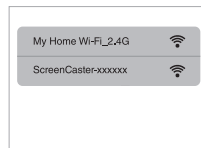

2. Connecting TVFix to the Internet
 - a. Open your Internet browser and go to <http://192.168.49.1>
 - b. Select your home Wi-Fi network and enter your home Wi-Fi password to connect.
 - c. Once TVFix is successfully connected to the internet, it will automatically disconnect from your mobile device.

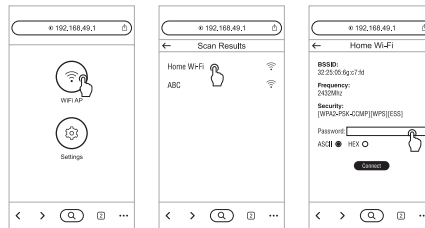

Casting Your Android Device:

1. Locate the Mirroring or Casting Function
 - a. **Samsung:** Smart View
 - b. **Huawei:** Multi-Screen
 - c. **LG:** MiraCast
 - d. **Motorola:** 'Cast' or 'Mirror'
 - e. **Sony Xperia:** Xperia Connectivity > Screen mirroring
 - f. **Xiaomi:** Wireless Display
 - g. **Other brands:** Sometimes the 'Wireless Display' or 'Cast' function may be located under the 'More' or 'Additional Settings' option of your smartphone settings.

You may also cast using many free apps such as EZMira, which can be found in your device's app store.

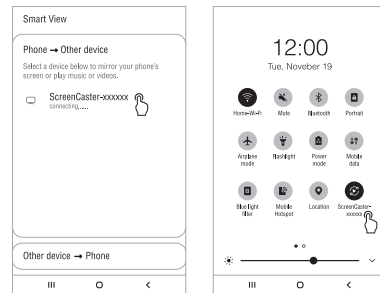

2. Google Home App Mirroring

- Make sure your mobile device and TVFix are connected to the same Wi-Fi network.
- Open the Google Home app.
- Tap the device 'ScreenCaster-xxxxxx'.
- Tap 'Cast my screen' and your smartphone's display will be cast to your big screen.

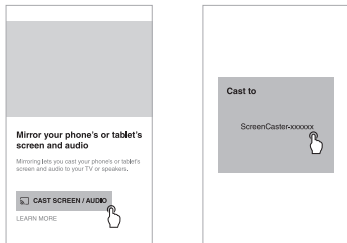
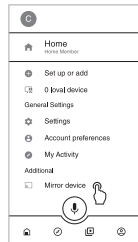

Casting Your iOS/Mac Device:

- Connect your iOS/Mac device to TVFix's SSID via Wi-Fi.
- Turn on Screen Mirroring/AirPlay mirroring and tap 'ScreenCaster-xxxxxx' to stream from your TVFix.
- Your device's display will now be casting to your big screen.

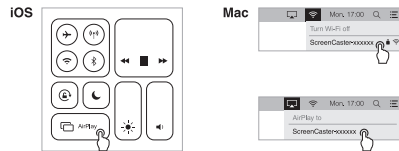

Casting Your Windows Device:

- Projection Mode (available for Windows 8.1 and Windows 10)
 - Press the shortcut "Win+P" on your keyboard.



- Select "Connect to a wireless display".
- Select 'ScreenCaster-xxxxxx' to connect.

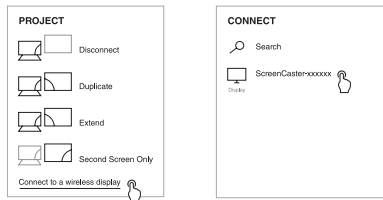

2. EZMira Mirroring (for Windows 7 and 8.0)

- Download EZMira from <https://mirascreen.com/pages/download-ezmira-for-windows> and install the EZMira software to your PC.
- Turn on Wi-Fi and connect to the 'ScreenCaster-xxxxxx' SSID. Enter the the password 12345678 when prompted.
- Open the EZMira software and select "Search Device".
- Select 'ScreenCaster-xxxxxx' and your PC screen will mirror to the TV automatically.

Note: Turn off the Windows firewall/anti-virus software if you cannot detect your device.



Technical Specifications:

Product Size	59 x 57 x 16 mm
Product Weight	54g
Material	ABS
Power	5V/2A max.
Frequency	2.4GHz
Wi-Fi speed	Up to 150Mbps
Resolution	Supports H.265/HEVC, 4K, 1080p
Video Format	AVI, FLV, MKV, MOV, RM, TS, VOB
Radio Format	AAC, APE, FLAC, MP3, OGG, WAV, WMA
Image Format	BMP, GIF, JPEG, JPG, PNG

☑ The device complies with the European Directives 2014/30/EU.

♻ At the end of its service life, this product may not be disposed of in the normal household waste, but rather must be disposed of at a collection point for recycling electrical and electronic devices. The materials are recyclable according to their labelling. You make an important contribution to protecting our environment by reusing, recycling, or utilizing old devices in other ways. Please ask the municipal administration where the appropriate disposal facility is located.

Subject to change.